

An aerial photograph of Springfield High School and its surrounding area. The school building is a large, multi-winged structure with a central courtyard. To the right of the main building is a large, open field, likely a sports field. The school is surrounded by a dense residential neighborhood with many houses and trees. The overall tone of the image is muted, with a blue overlay at the top and bottom.

Springfield High School

Springfield School District
Delaware County - Pennsylvania

Master Plan Presentation

Town Hall Meeting 2

Existing Building / Right-Sizing/ Education Model

November 13th, 2014

Town Hall Meetings

- **Town Hall Meeting 1** (October 16th, 2014)
Repeat Presentation of May 22, 2014 Board Meeting
- **Town Hall Meeting 2** (November 13th, 2014)
Existing Building / Right-Sizing / Education Model
- **Town Hall Meeting 3** (December 11th, 2014)
Phasing / Traffic and Parking
- **Town Hall Meeting 4** (January 14th, 2015)
Community/ Academic / Athletics and Recreation / Sustainability
- **Town Hall Meeting 5** (February 4th, 2015)
Financial Options / Cost Options / Tax Impact
- **Town Hall Meeting 6** (March 19th, 2015)
Recap / Summary / Options for Moving Forward

Town Hall Meeting 2

Existing Building / Right-Sizing / Education Model

Presentation Outline

- Existing Facility
- Right Sizing the 'Box'
- Education Goals
- Discussion

An aerial photograph of a school campus. The central feature is a large, multi-story school building with a flat roof. To the right of the main building is a large, rectangular athletic field, likely a football field, with a visible end zone. To the left of the main building is another rectangular field, possibly a baseball or softball field. The campus is surrounded by a dense residential neighborhood with many houses and trees. The text "Existing Facility" is overlaid in the center of the image in a dark blue, serif font.

Existing Facility

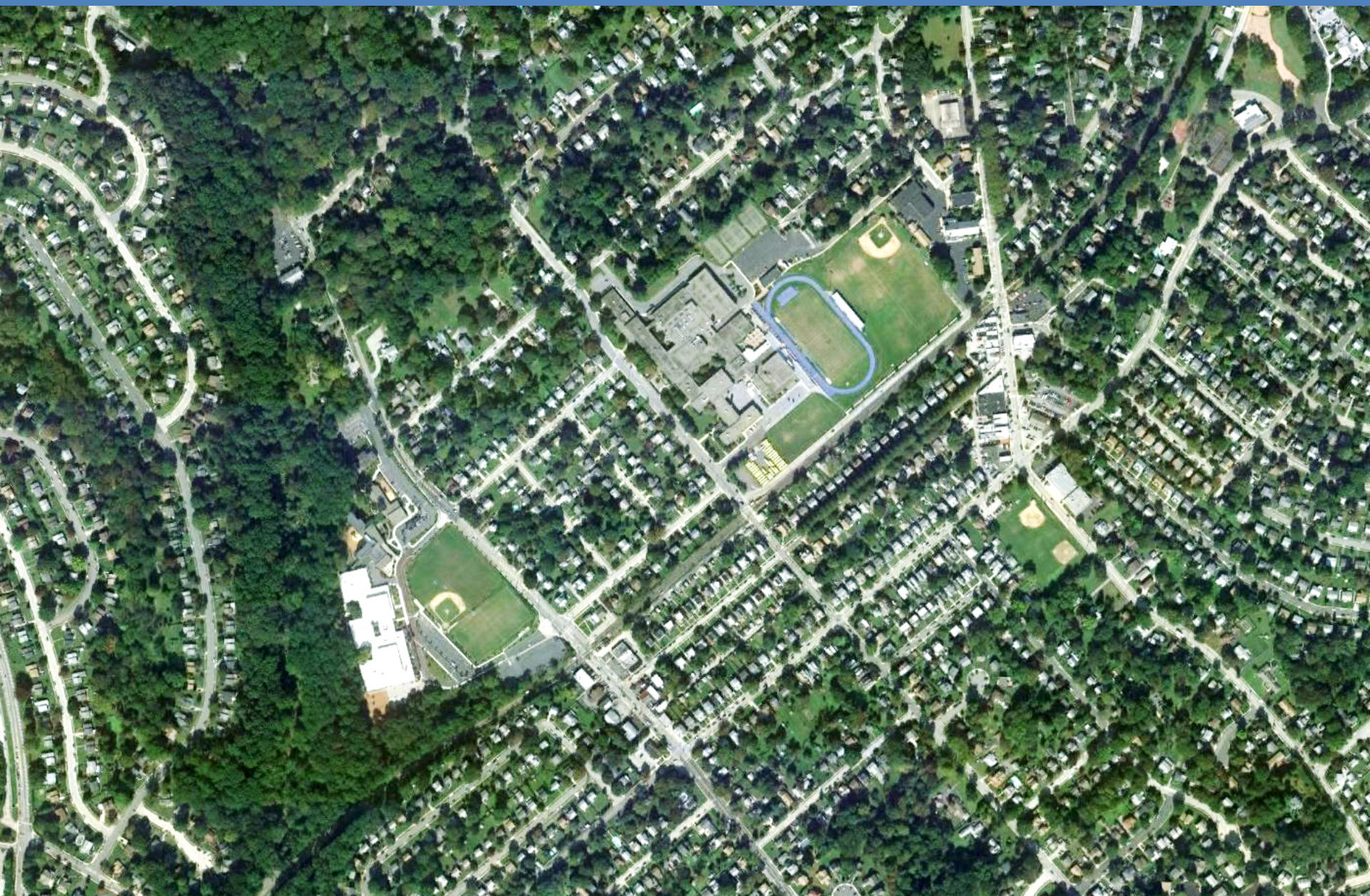

Current approach to the existing facility:

- SSD has continued to track and manage upcoming maintenance, replacement / upgrade issues (S.L.E.P.)
 - Window sealant repair and refinishing
 - Exterior plaster repair and maintenance
 - On-going repair & maintenance of critical building systems & components
 - Focused roof/exterior wall repair @ walls by Auditorium
 - Canopy maintenance/life extension – structural concern regarding columns themselves
 - Bathroom/cafeteria upgrades
 - Bleacher replacement
 - Targeted brick repointing
- Many of the building elements needing replacement / upgrades are building-wide elements
- Deliberate effort to limit recent focus on life-safety and other urgent maintenance issues, in order to evaluate best long-term approach (master plan efforts)
- Some maintenance and upgrade efforts deferred or delayed, to create the time and financial capacity to provide the District with options (renovate or construct new)



Code



Roofing



Windows



Envelope



Electric



Asbestos Roof Deck



HVAC



Plumbing



Composite of Issues

Existing building does not meet the current , more stringent building codes (exit stairs, hallway, fire separation, etc.)



Composite of All Floors





Membrane and insulation replacement required

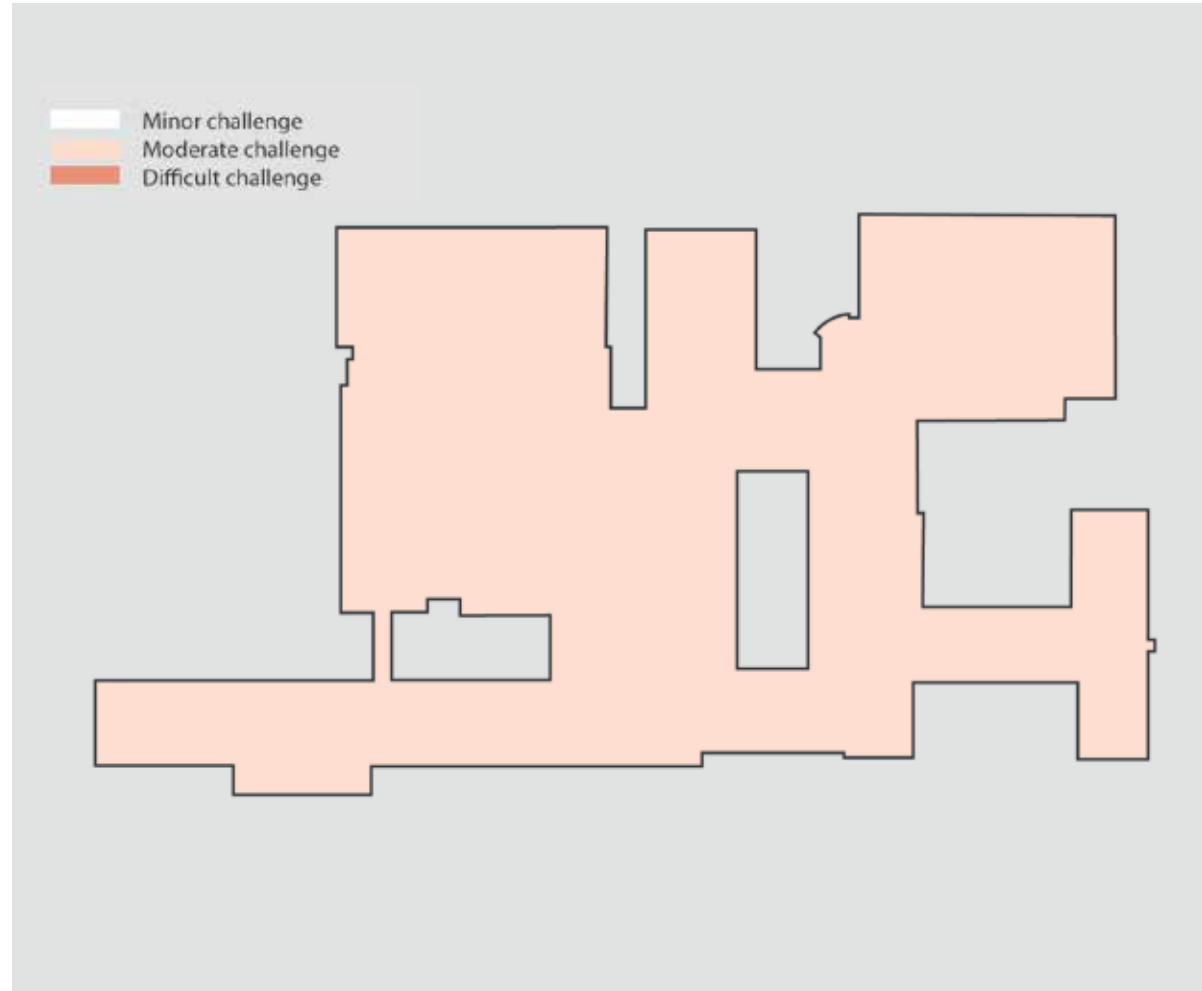

Composite of All Floors

Asbestos containing roof panels



Composite of All Floors



Older windows poor energy performance

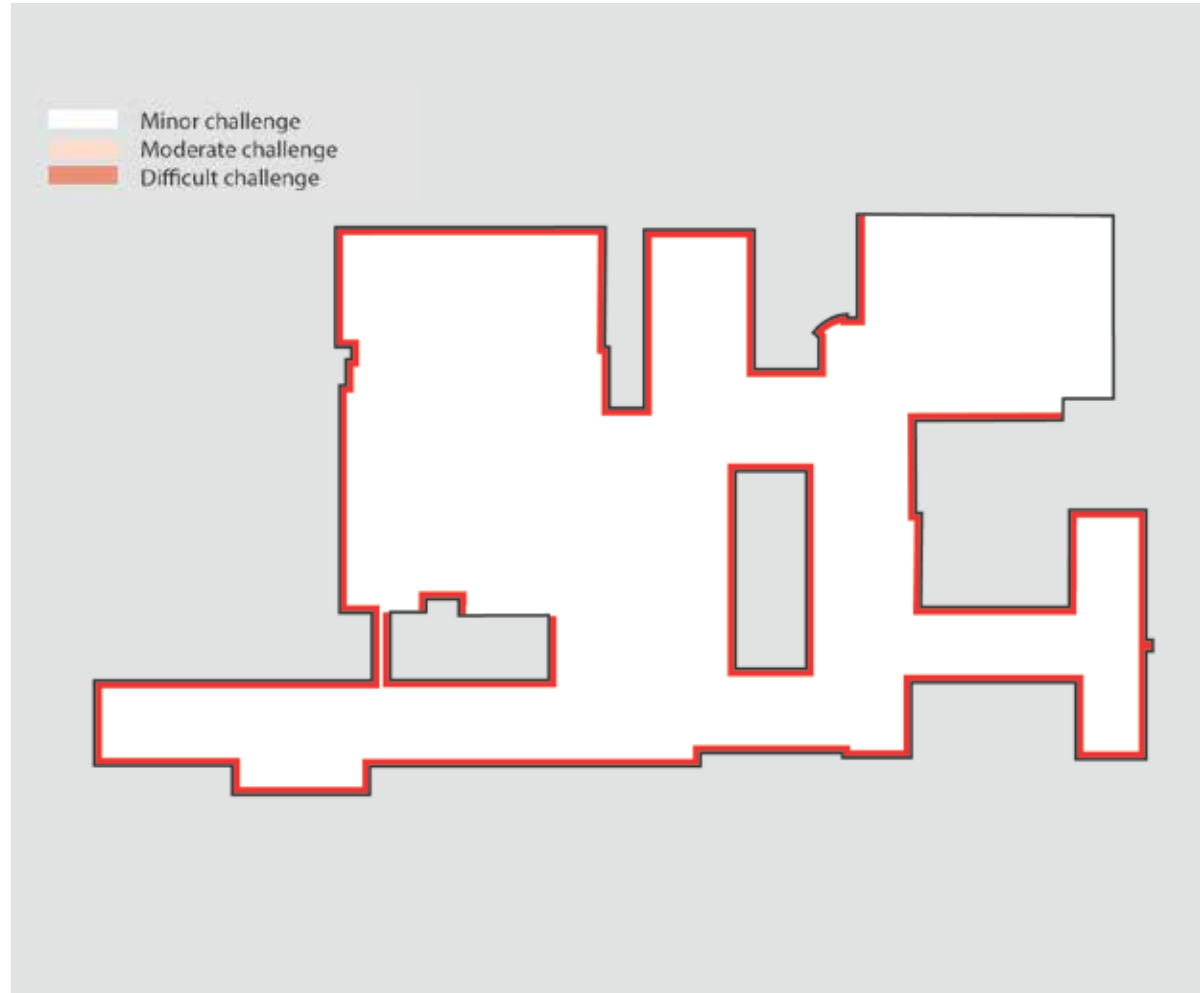

Lack of insulation and poor energy performance

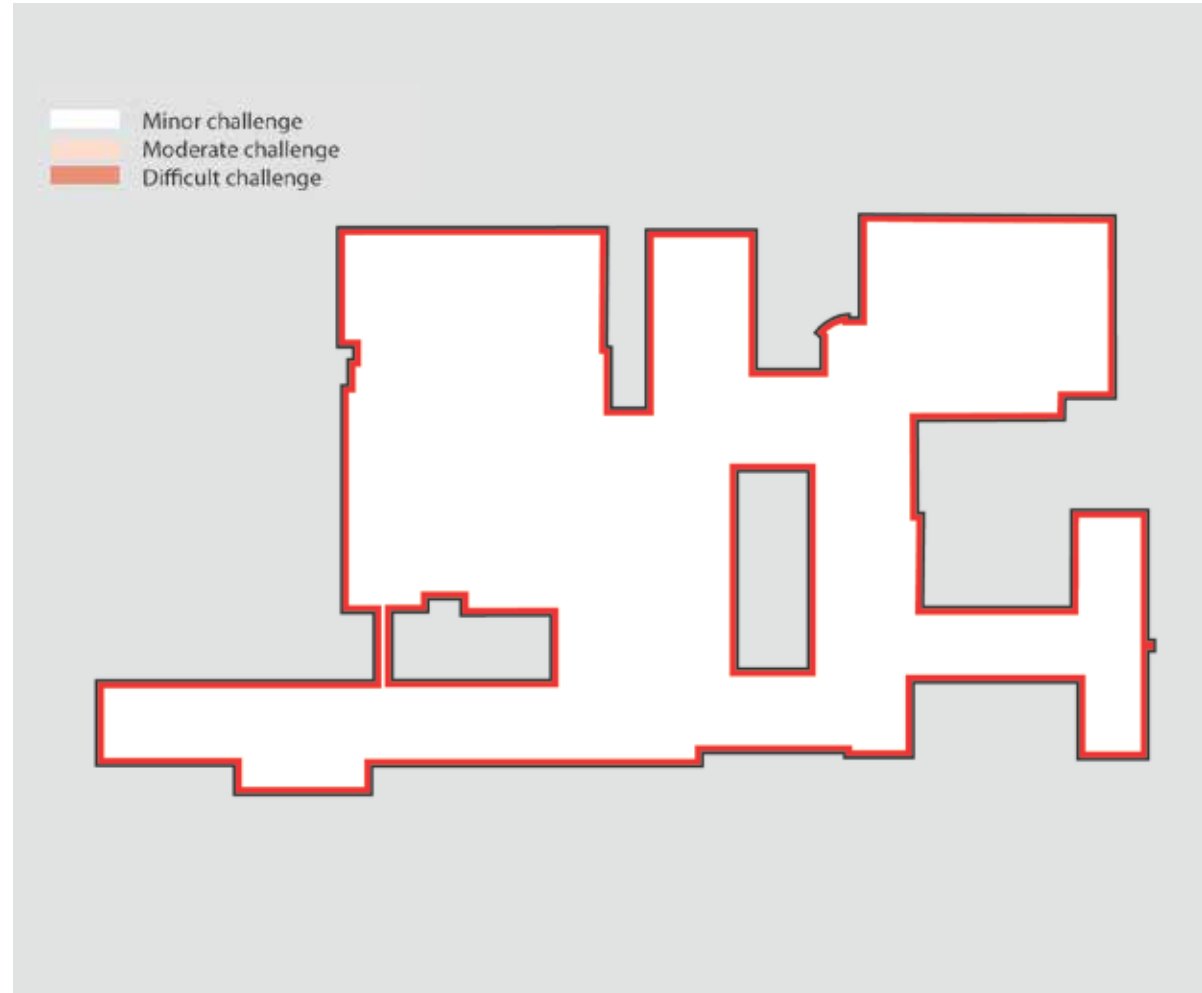

Composite of All Floors

Recent building envelope leaks observed following the last major rain event (May 16, 2014)

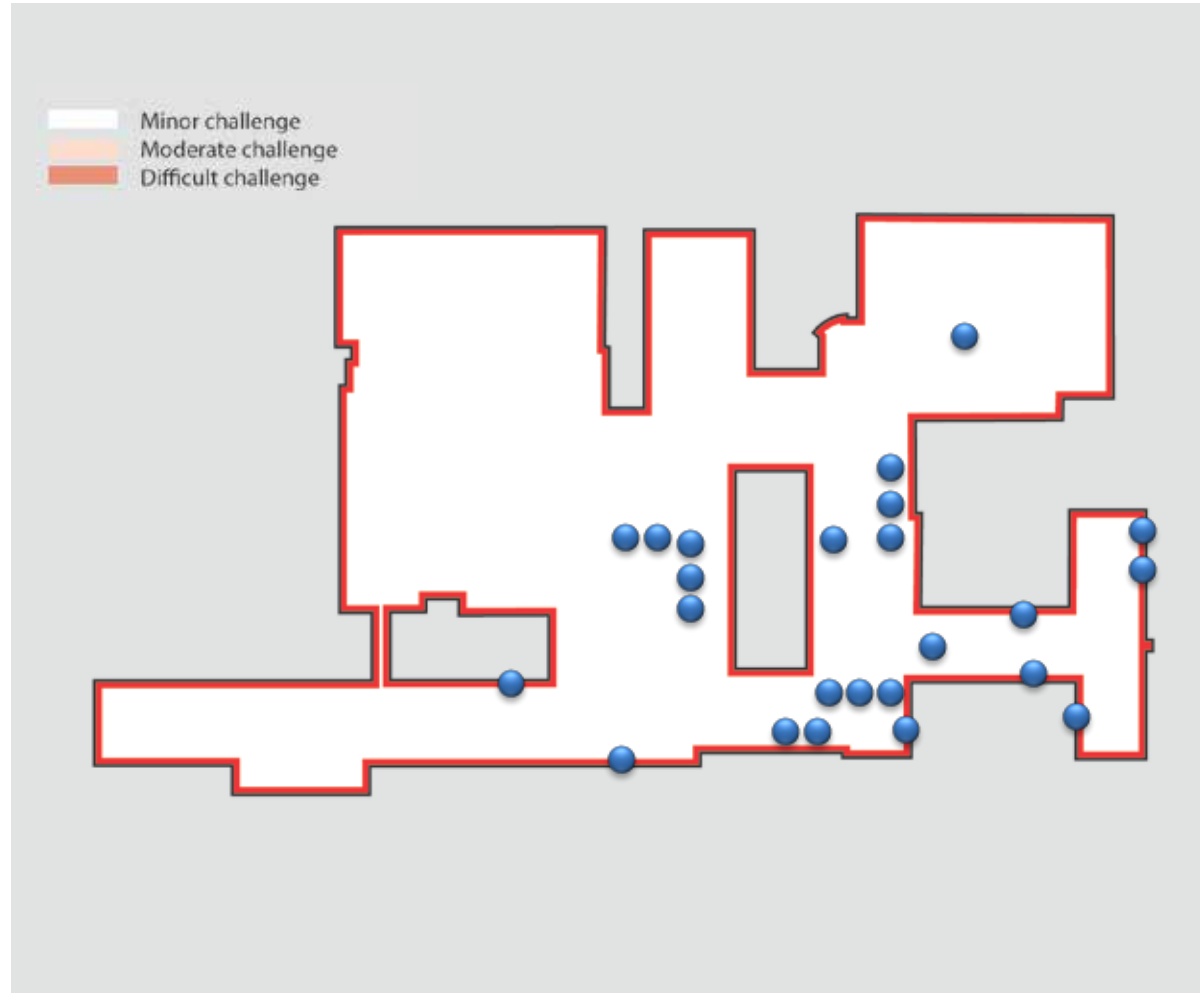

Composite of All Floors



Outdated and undersized electrical systems



Composite of All Floors



Outdated or nonexistent heating and ventilation, with very limited A/C systems area

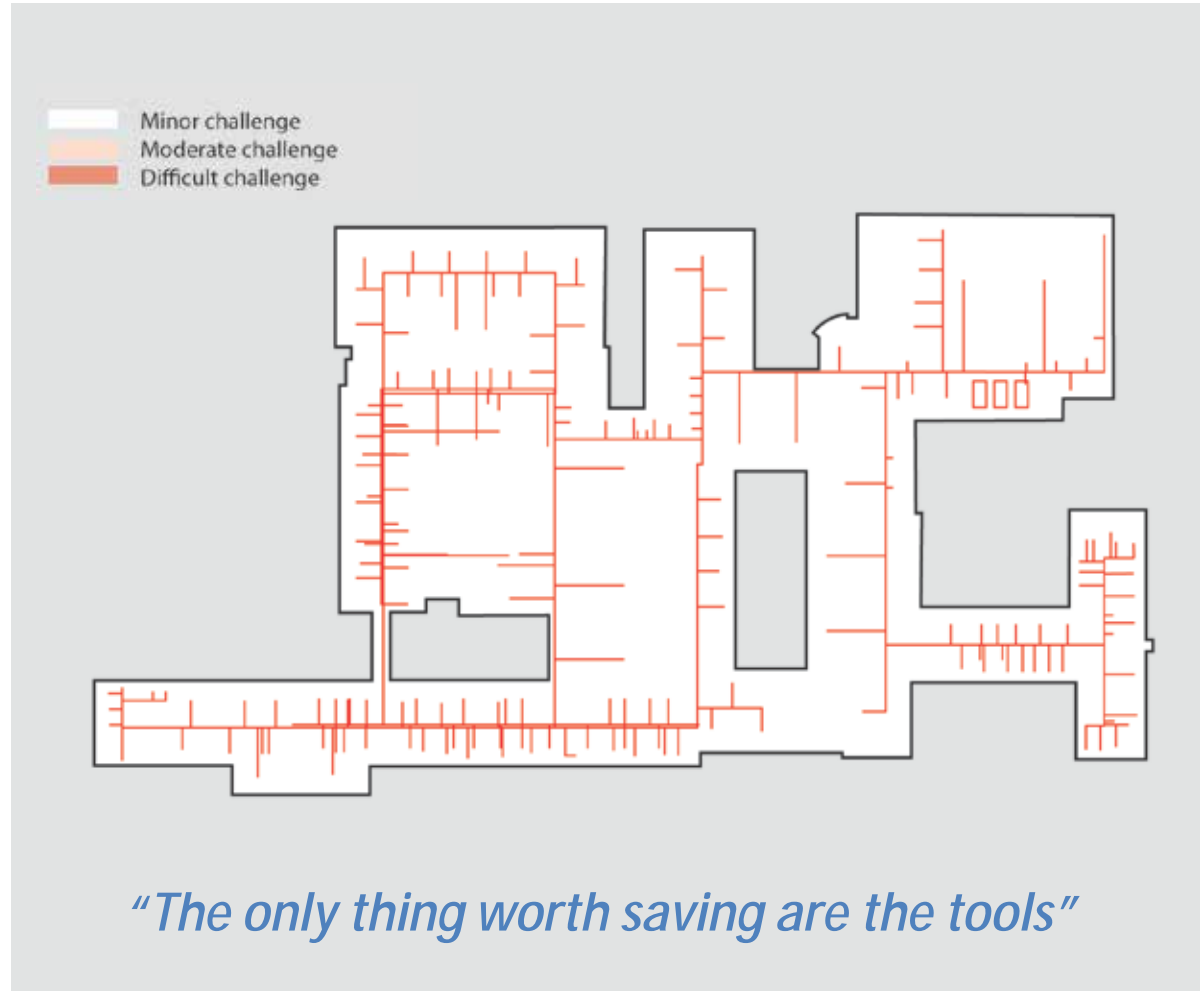

Composite of All Floors





Outdated plumbing systems approaching end of service life

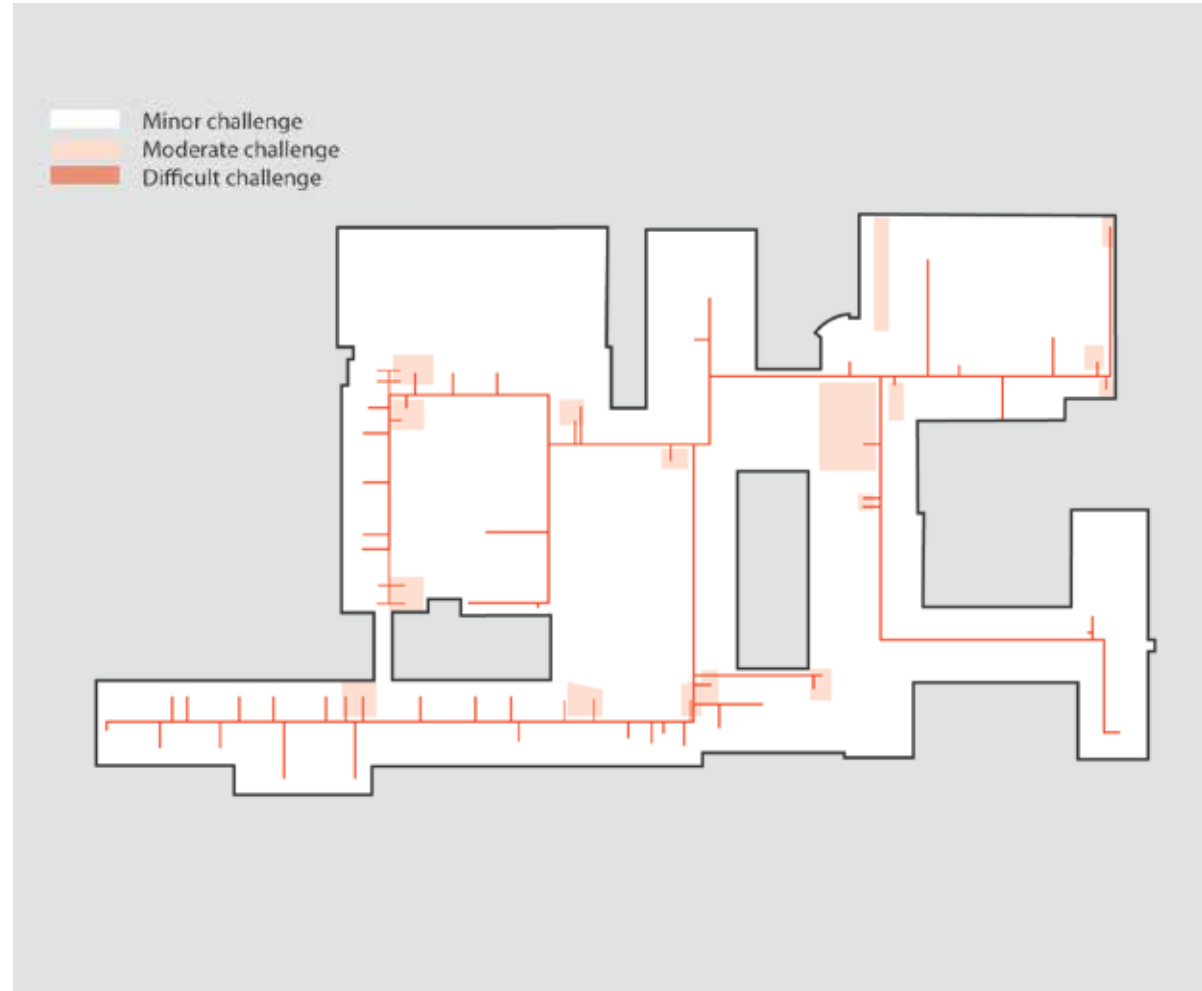

Composite of All Floors





Code



Roofing



Windows



Envelope



Electric



Asbestos Roof Deck



HVAC



Plumbing



Composite of Issues

Site tours will be held on the following dates:

Saturday November 15, 10:00AM

Saturday November 22, 10:00AM

Meet at the main entrance of the High School on Leamy Ave.

An aerial photograph of a school campus. The central feature is a large, multi-story school building with a complex roofline. To the right of the main building is a large, oval-shaped sports field, likely a football or soccer field. To the left of the main building is another sports field, possibly a baseball or softball field. The campus is surrounded by dense residential housing with many houses and trees. The text "Right Sizing the 'Box' / Program Goals" is overlaid in the center of the image.

Right Sizing the 'Box' / Program Goals

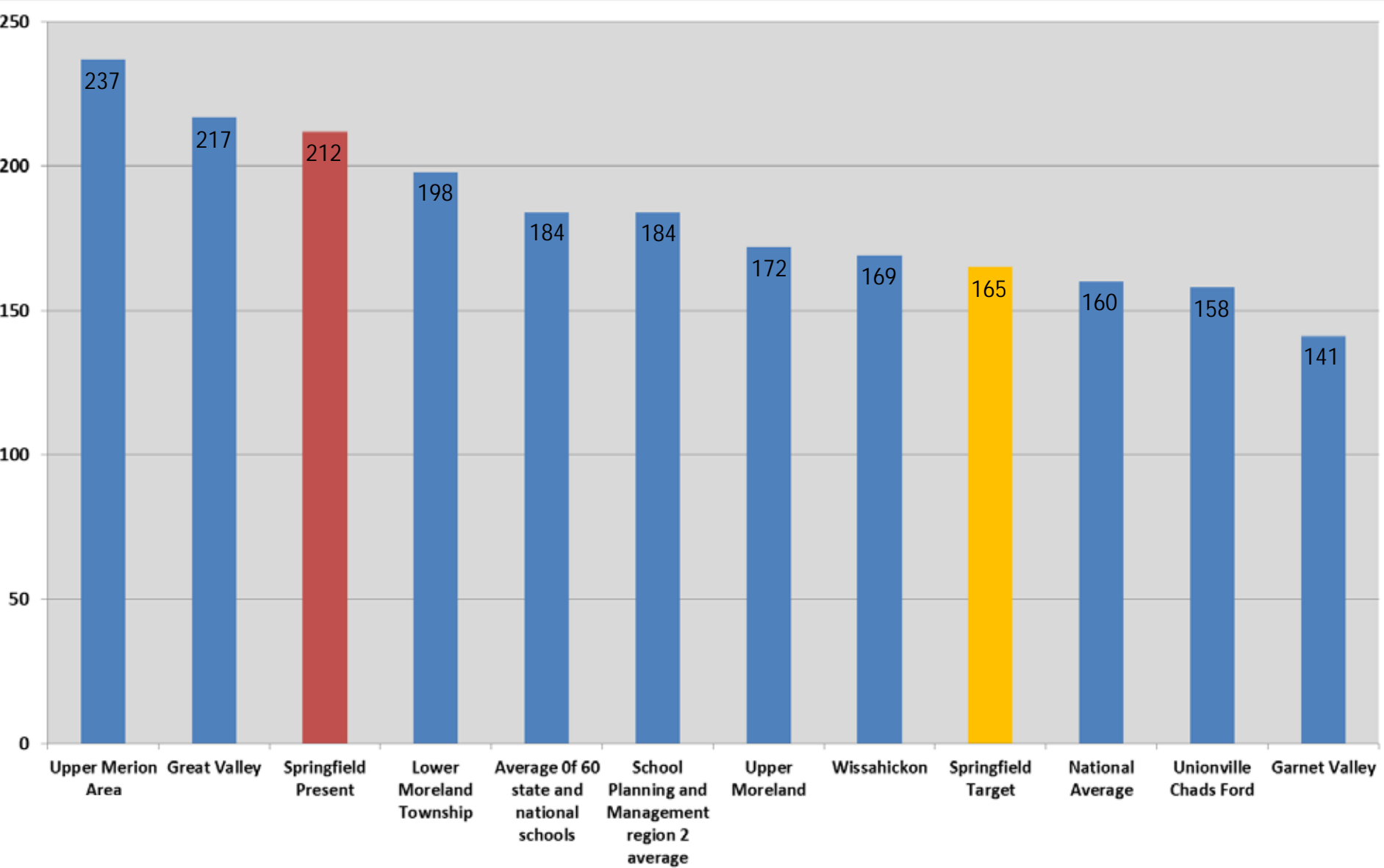

RIGHT SIZING THE 'BOX'

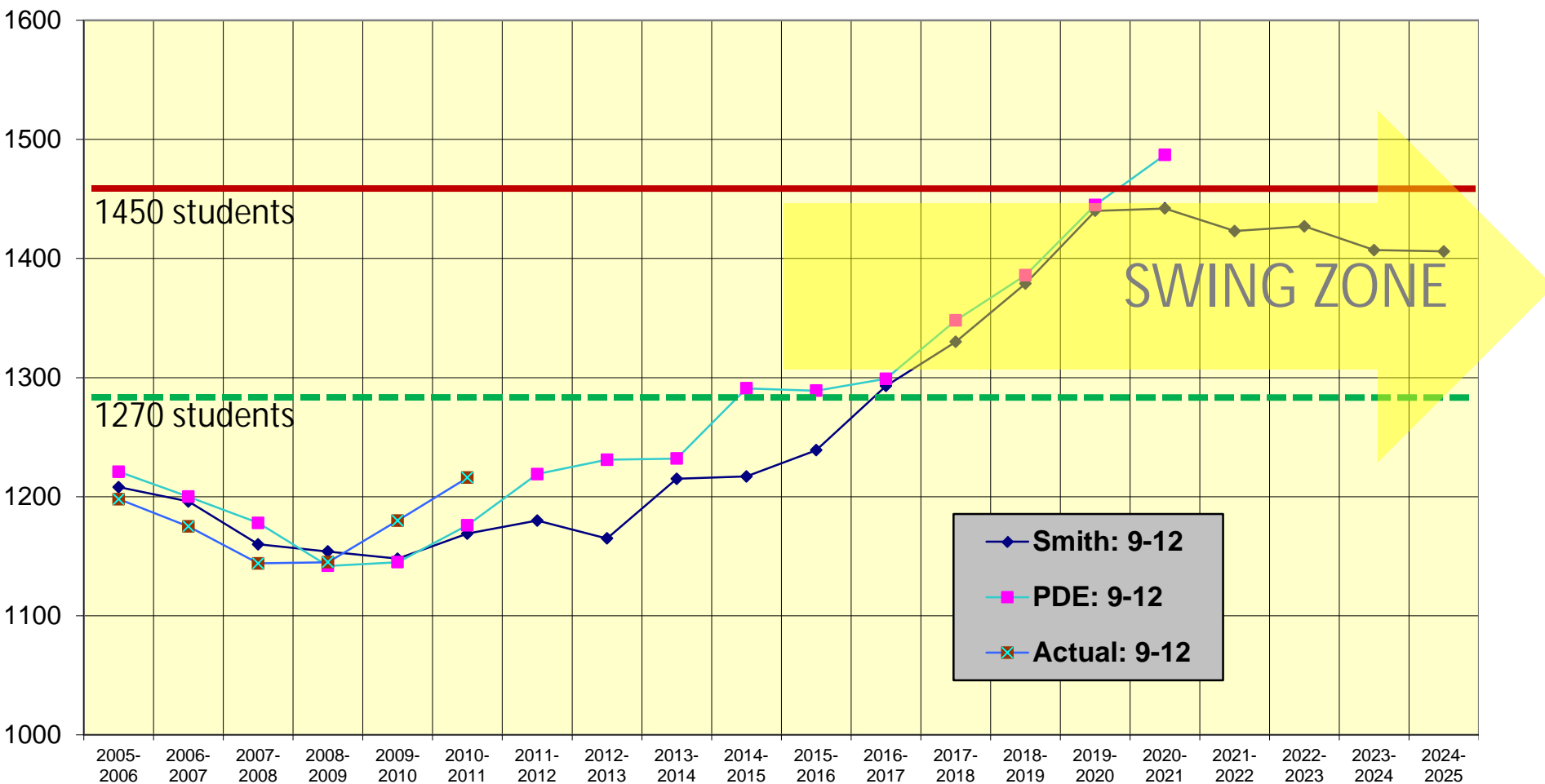

COMMITTEE CHARGE:

Assume maximum projection 1270 - expandable to 1450 students (implies 4400 total students)

Note: 85% of projected peak is 1233 students

- School Admin

Classrooms

Food

Media Center
- Auditorium

Physical Edu.

District Admin

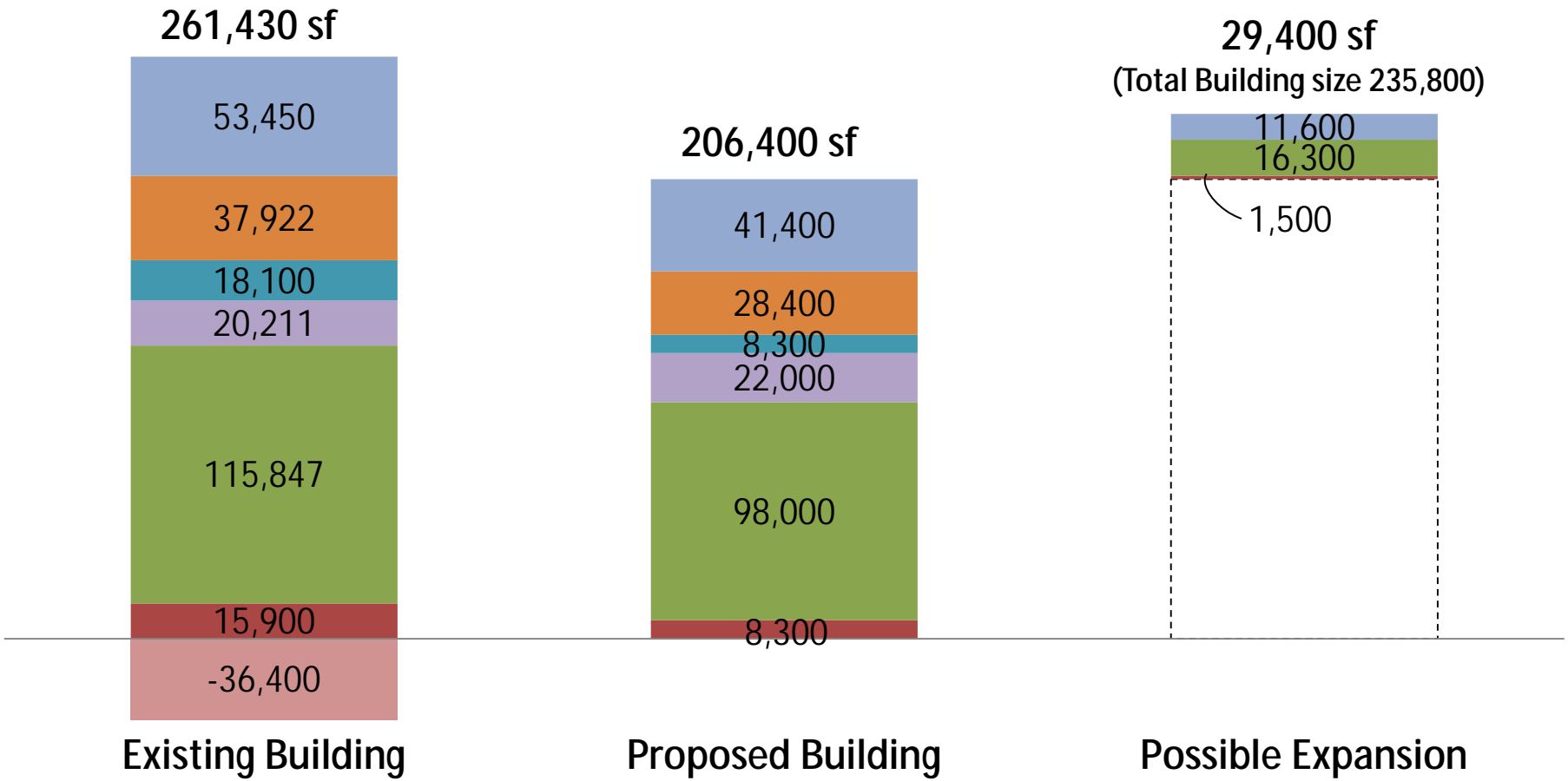

An aerial photograph of a school campus. The central feature is a large, multi-story school building with a complex roofline. To the right of the main building is a large, oval-shaped sports field, likely a football or soccer field. To the left of the main building is another sports field, possibly a baseball or softball field. The campus is surrounded by a dense residential neighborhood with many houses and trees. The text "Education Goals" is overlaid in the center of the image.

Education Goals

SPRINGFIELD PUBLIC ACADEMY

A new public post-secondary model for education

"Teach every student to LEARN"

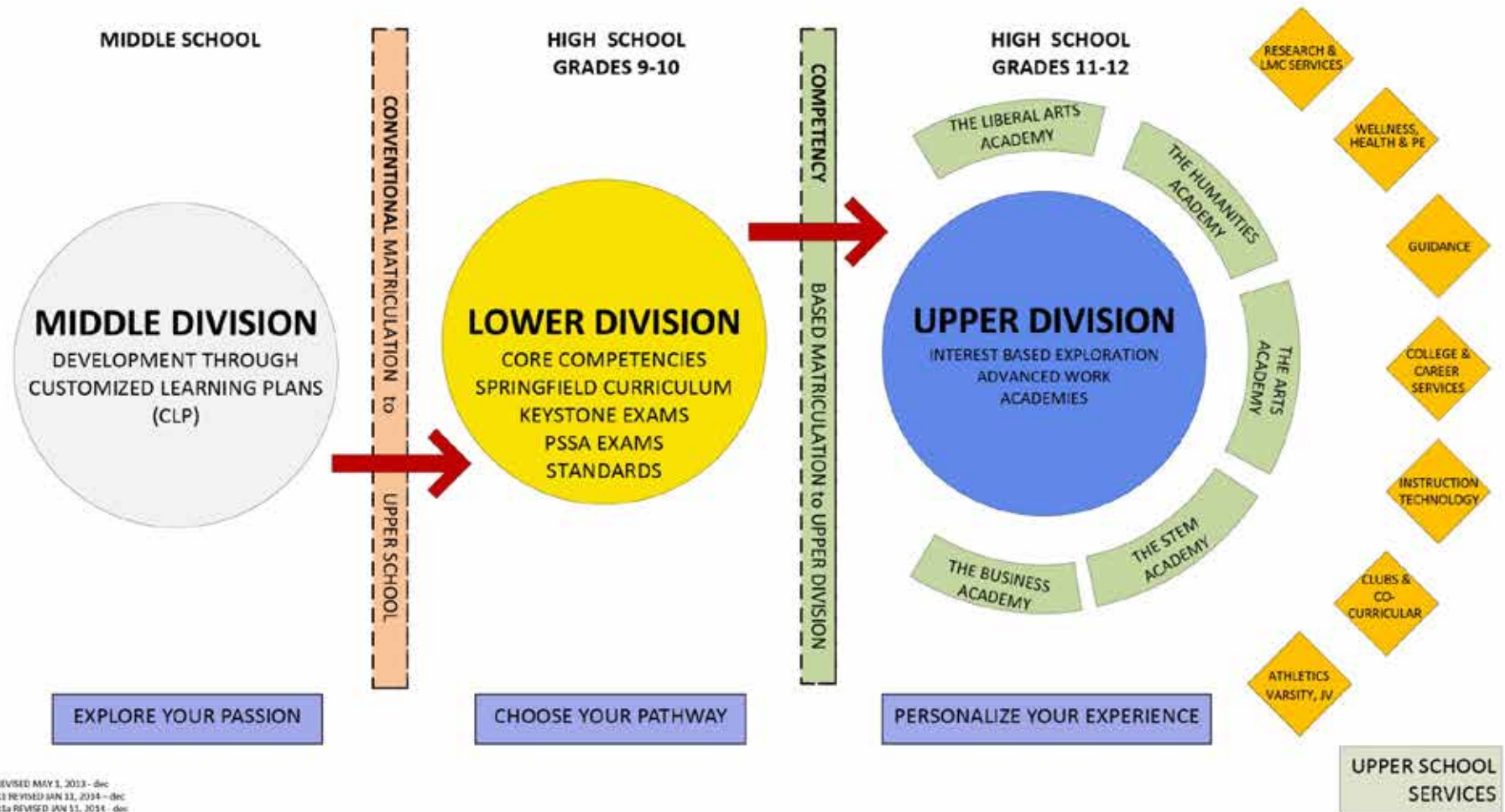

Lower Division: *Find your purpose*

- § Focused on developing core competencies and meeting requirements of Pennsylvania Department of Education



Organized departmentally with minimal elective based shared space

- | | |
|------------------|------------------|
| § Math | § Language Arts |
| § Social Studies | § World Language |
| § Science | |

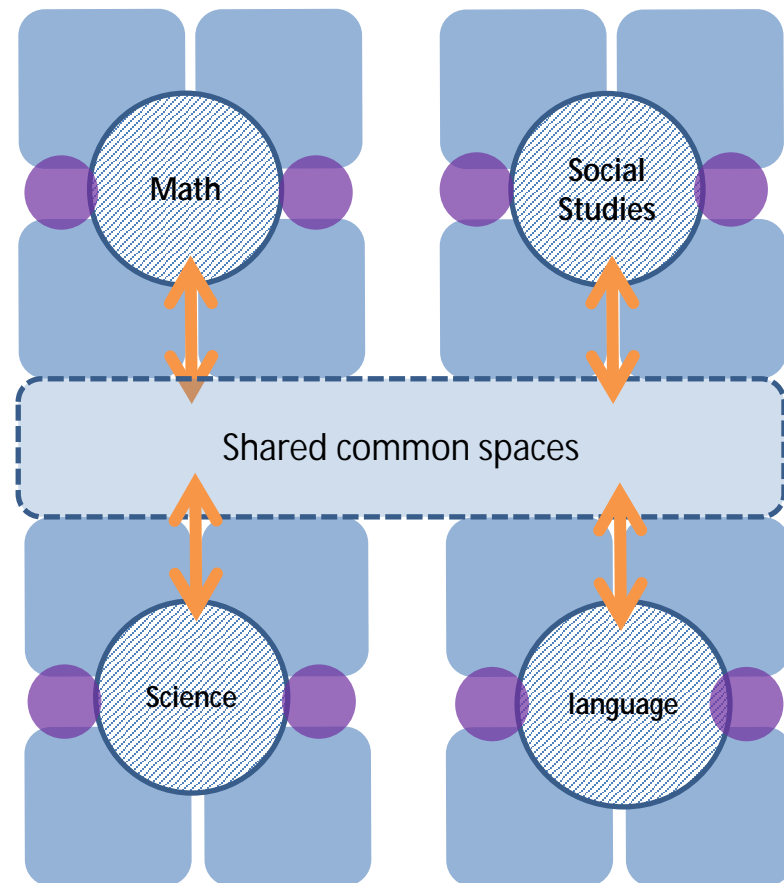

SPRINGFIELD PUBLIC ACADEMY

A new public post-secondary model for education

"Teach every student to LEARN"

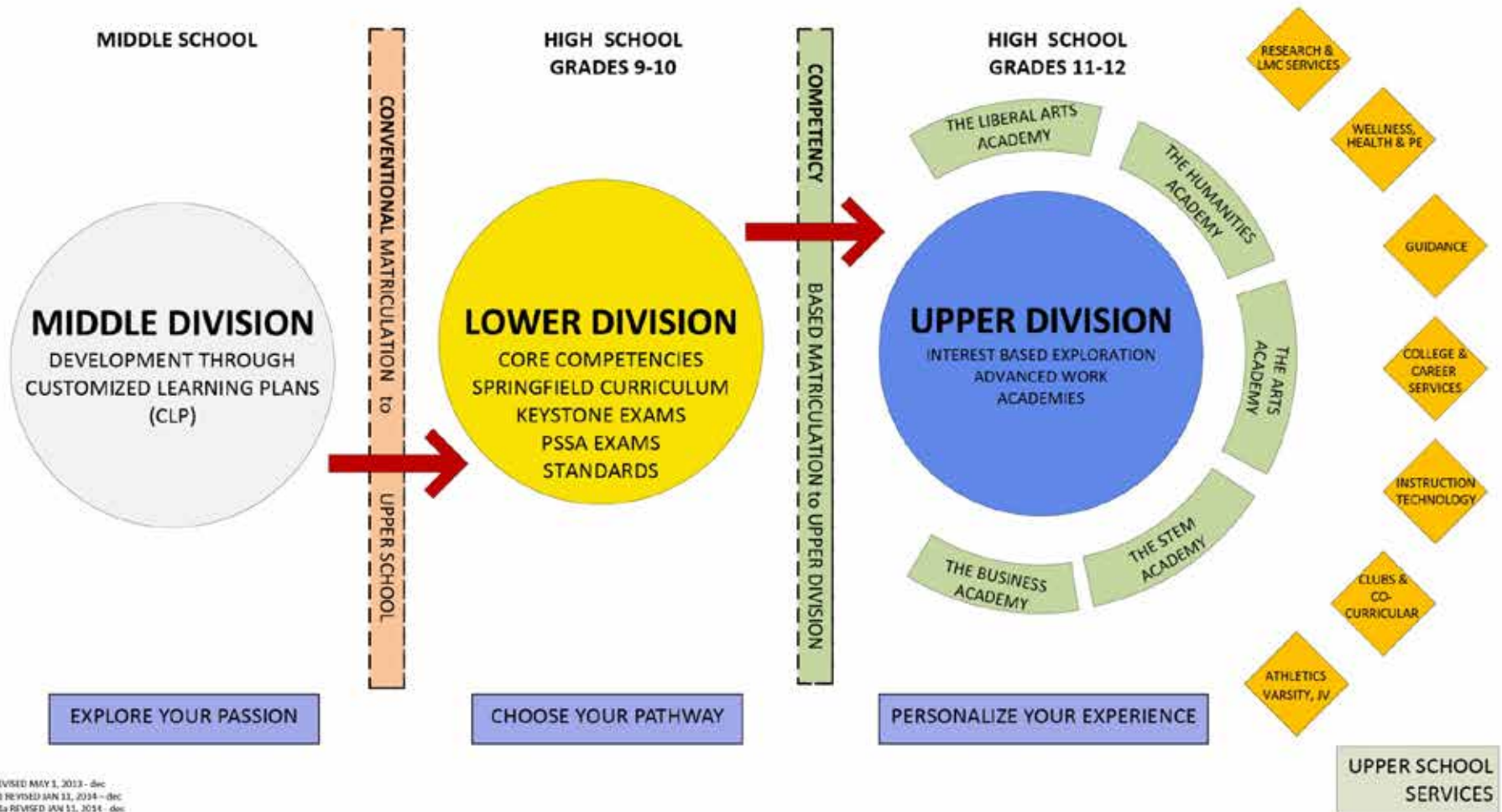

Upper Division: *Choose your pathway*

Mission: To provide an innovative, customized learning experience for each student that produces college and career ready, lifelong learners.



“collection of small learning communities”

- | | |
|--------------|----------------|
| § STEM | § Arts |
| § Humanities | § Liberal Arts |
| § Business | |

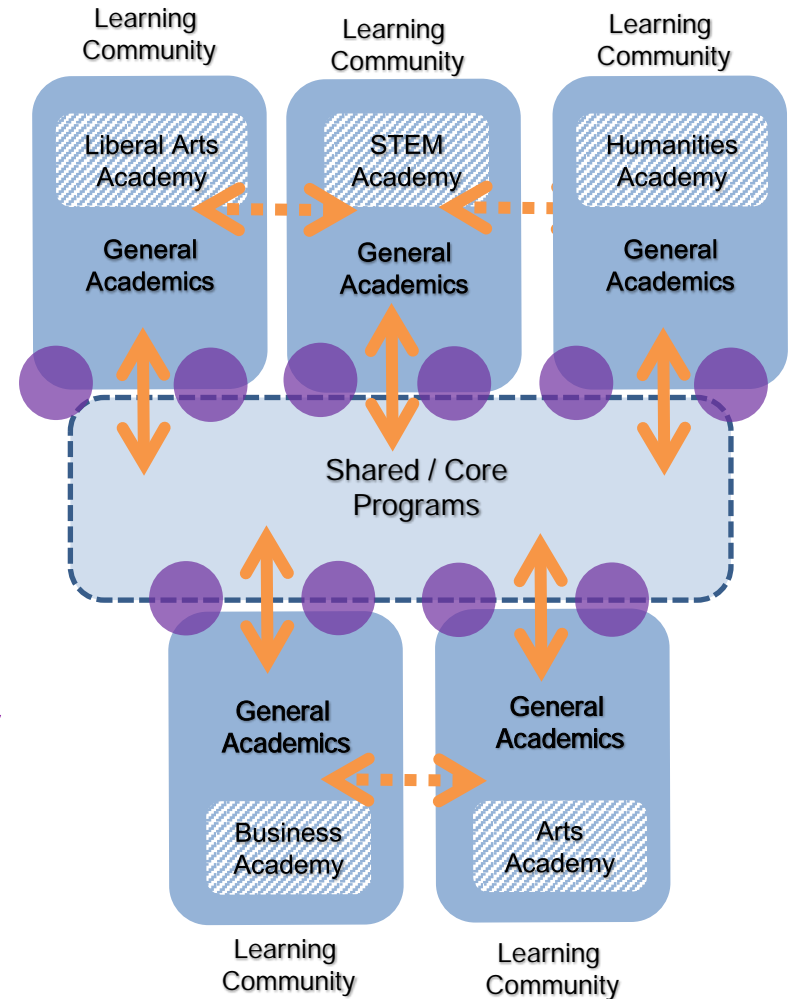

SPRINGFIELD PUBLIC ACADEMY

A new public post-secondary model for education

"Teach every student to LEARN"

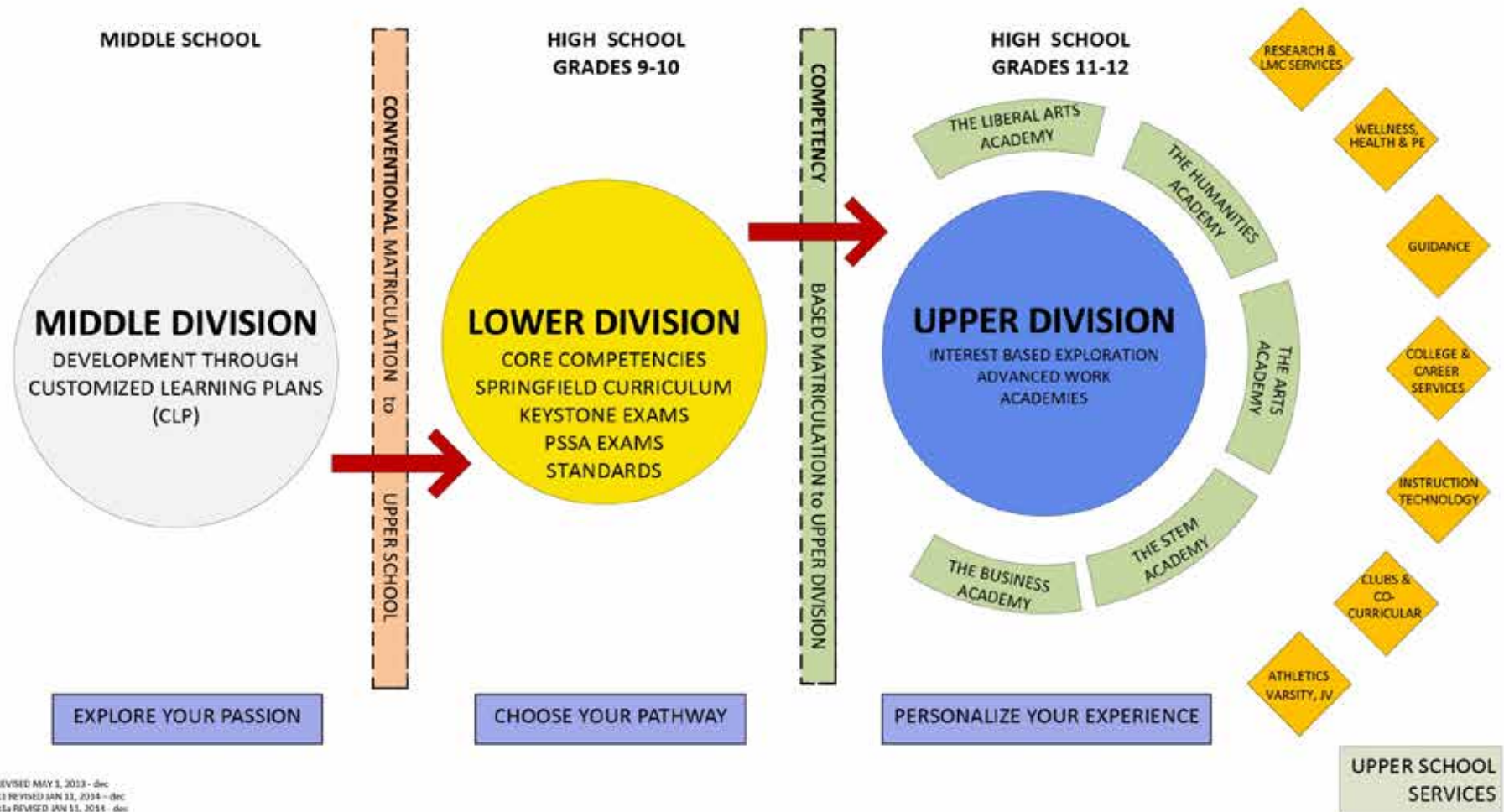

How has the Workplace Evolved?



Priority Shifts

From

- Work in the office
- Definitive hierarchy
- Limited Technology
- Fixed Work hours and schedule
- Climbing the corporate ladder
- Guarded information
- Control based Leadership

To

- Work from anywhere
- Interaction at all levels
- Ubiquitous Technology
- Flex hours
- Creating your own ladder
- Shared Information, mentorships
- Engaged & Empowered leadership



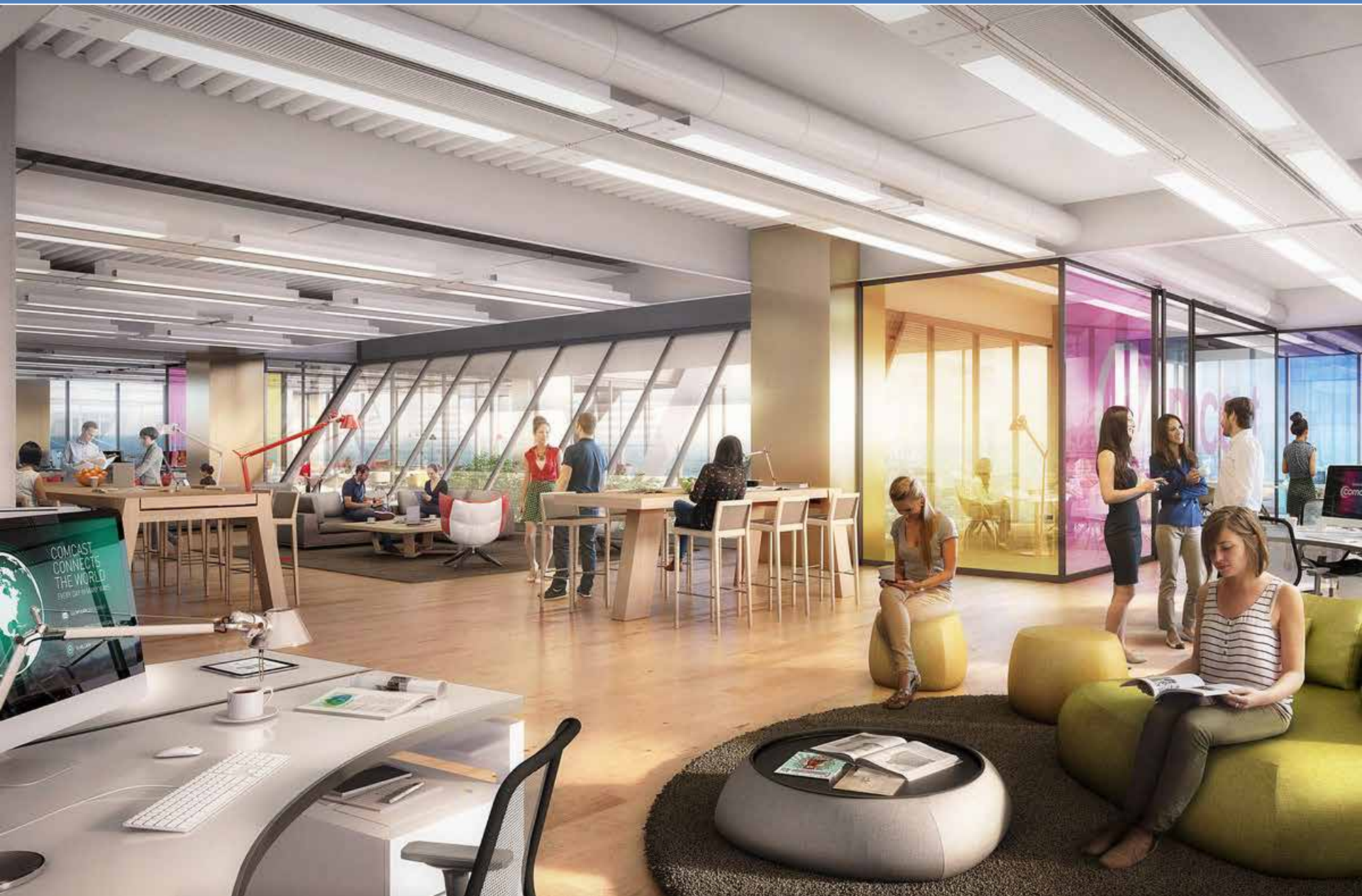



What is 21st Century Education?

- § 21st century skills:
 - § Critical thinking
 - § Collaboration
 - § Creativity
 - § Communication
- § Active
- § Learn by doing
- § Interactive discovery
- § Celebrate individuality
- § Student centric
- § Integrated Curriculum

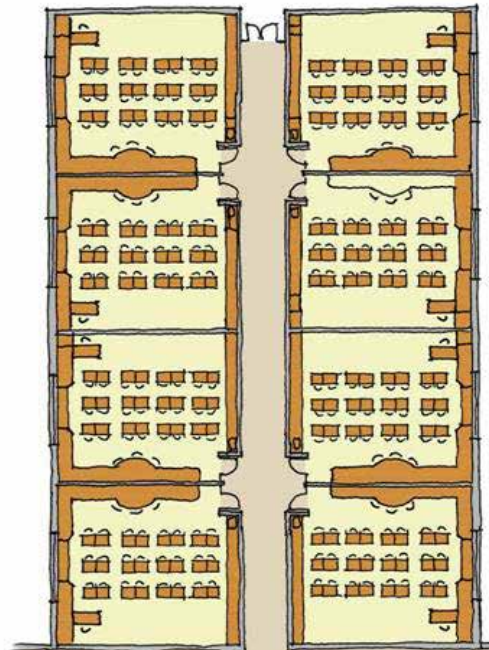

Traditional classroom configuration

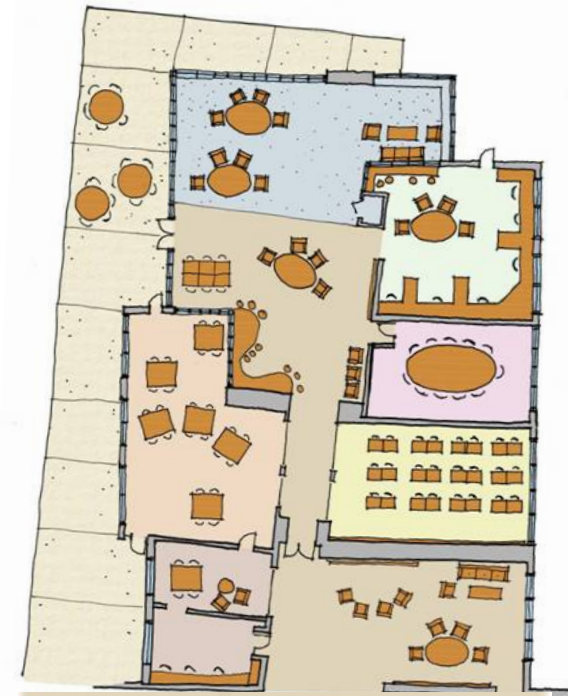

21st century classroom configuration

21st century classroom configuration

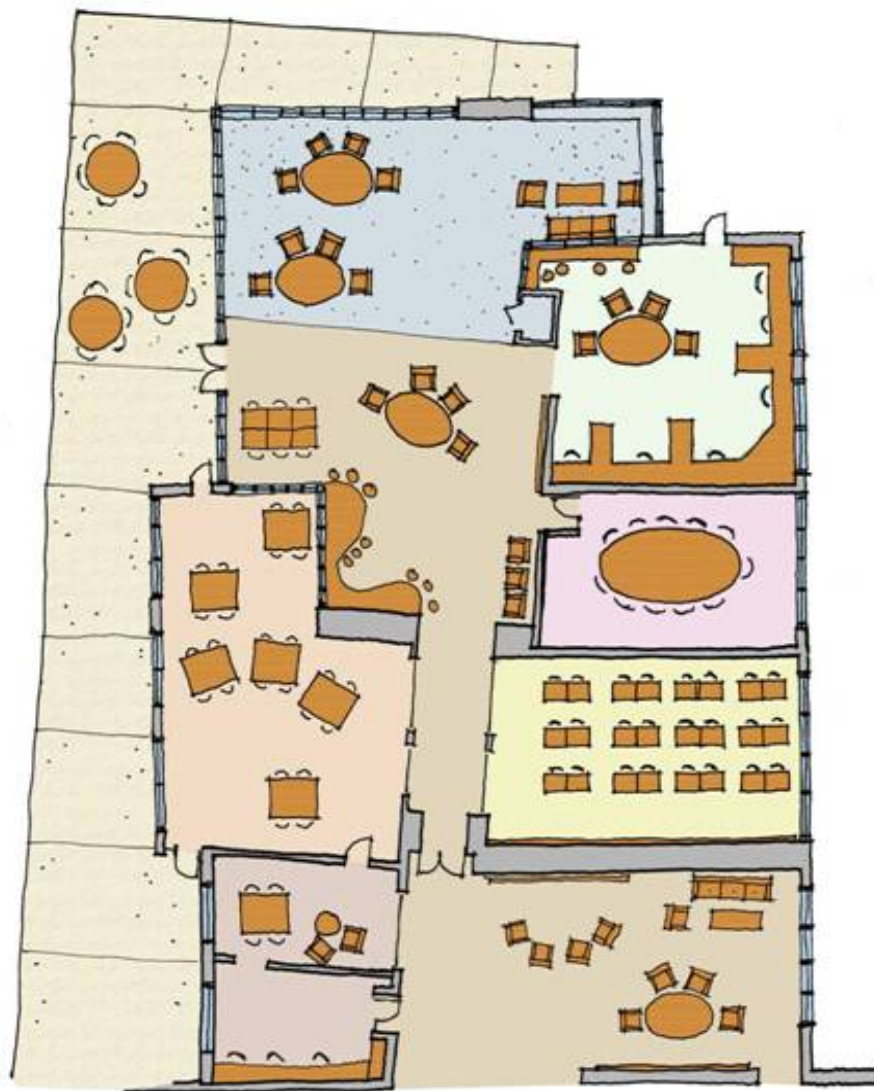

An aerial photograph of a suburban neighborhood. In the center, there is a large school complex with several buildings and a large oval-shaped sports field. Surrounding the school are residential streets with houses and trees. The text "Examples and Exemplars" is overlaid in the center of the image.

Examples and Exemplars







Existing Learning Resource Center



Springfield Literacy Center Library



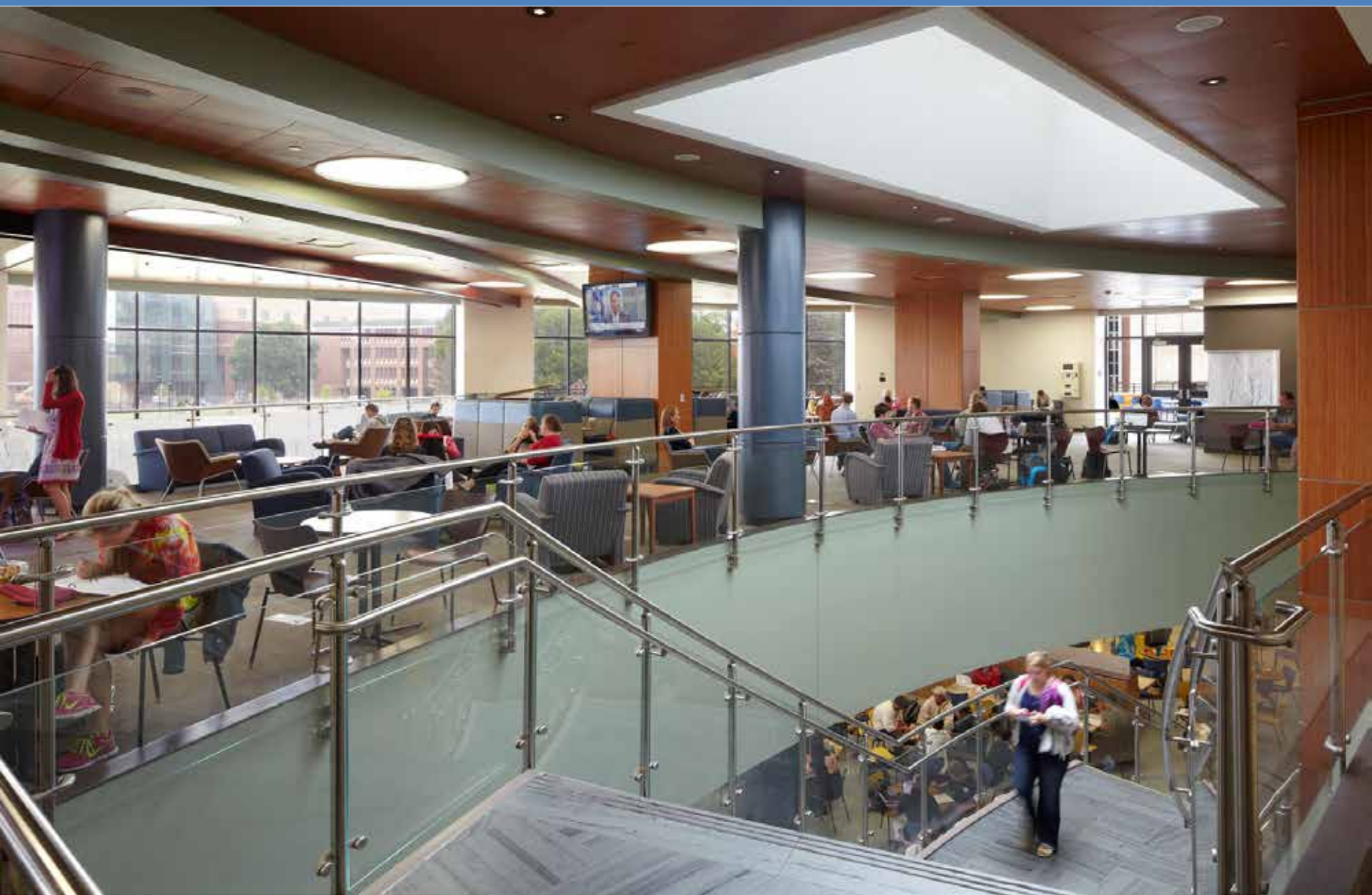





Existing Rehearsal Space



Exemplar Rehearsal

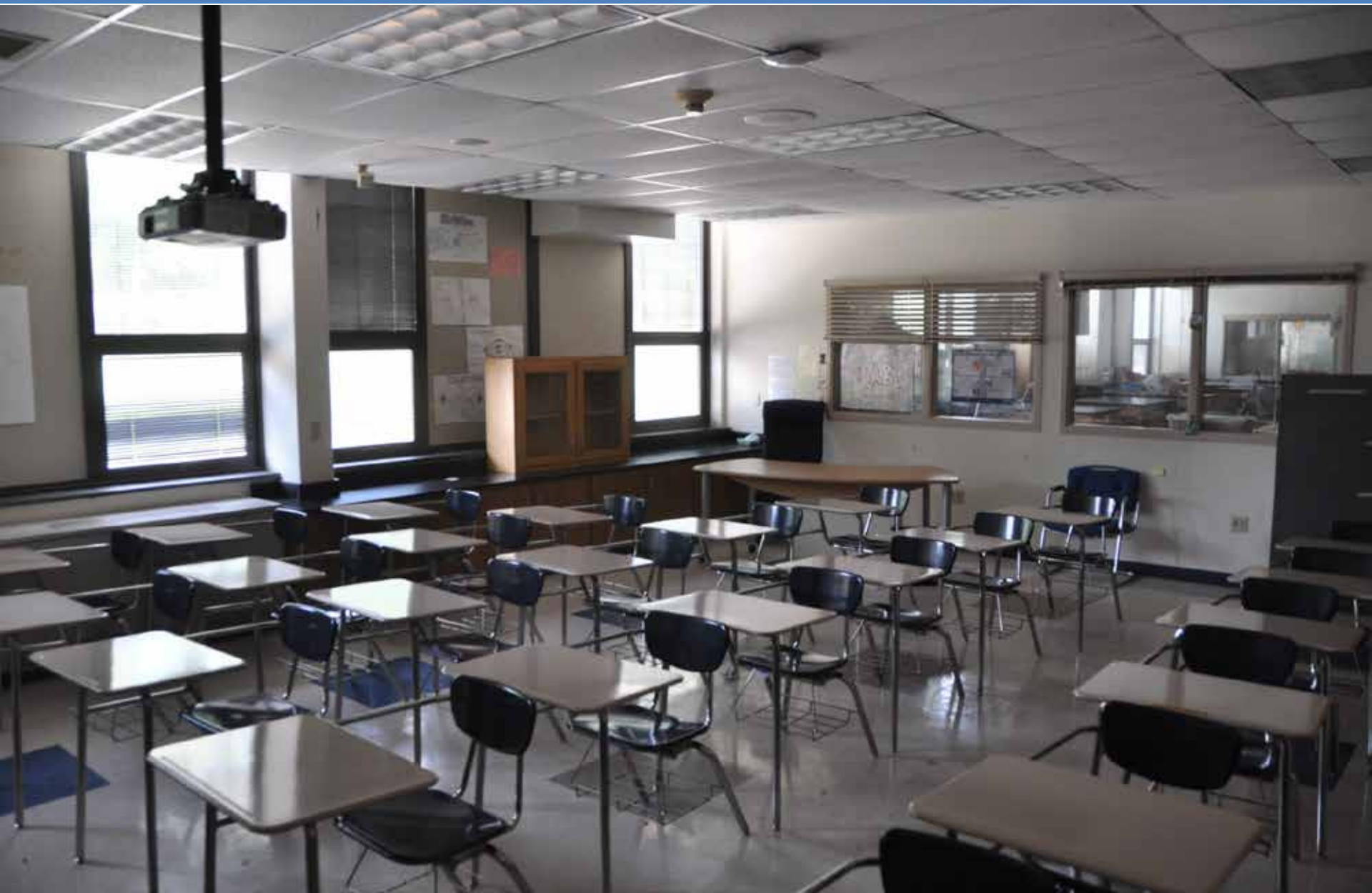



Exemplar Classroom





Exemplar collaboration space



Exemplar collaboration space

SPRINGFIELD PUBLIC ACADEMY

A new public post-secondary model for education
"Teach every student to LEARN"

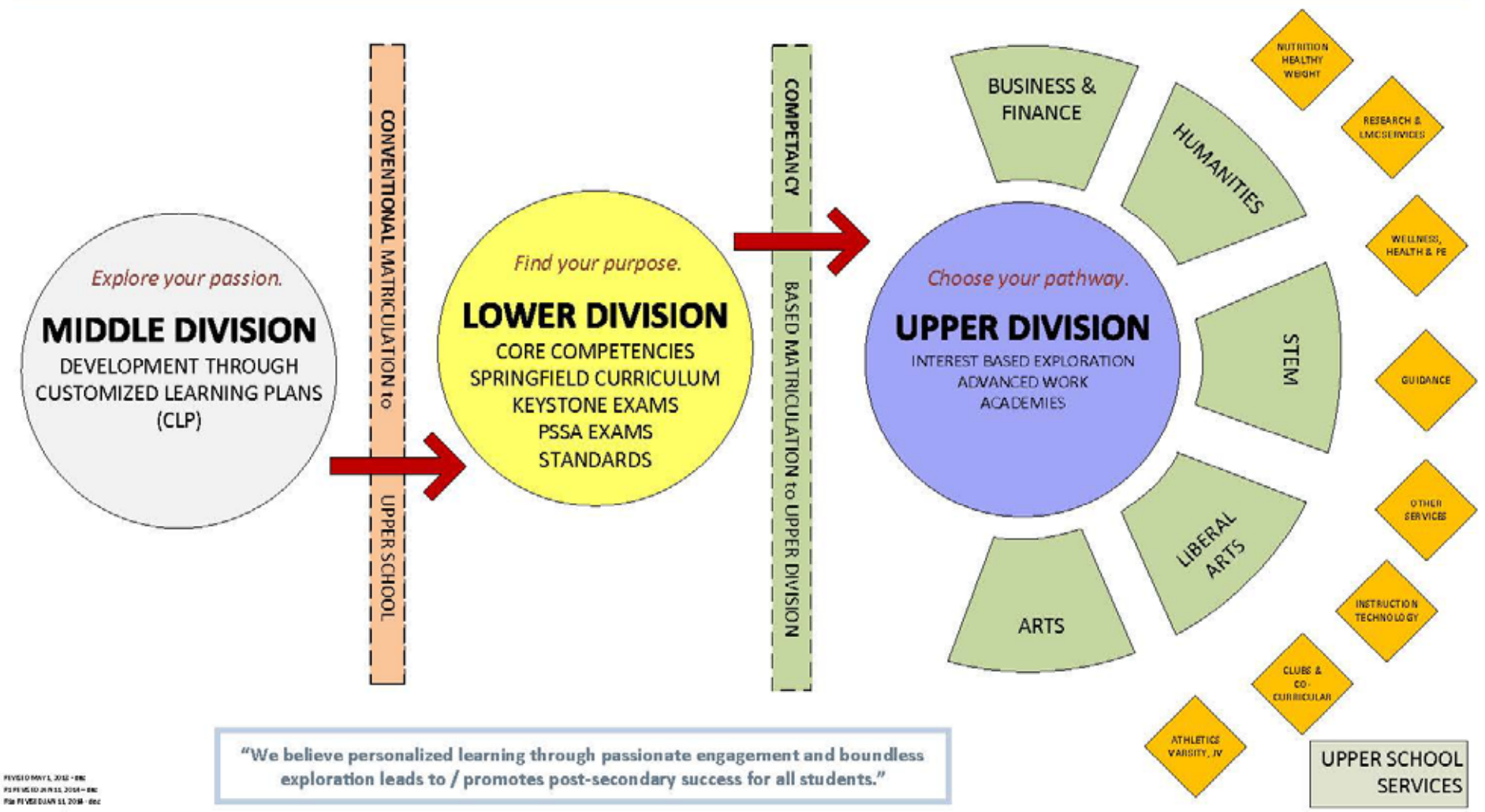

Town Hall Meetings

- **Town Hall Meeting 1** (October 16th, 2014)
Repeat Presentation of May 22, 2014 Board Meeting
- **Town Hall Meeting 2** (November 13th, 2014)
Existing Building / Right-Sizing / Education Model
- **Town Hall Meeting 3** (December 11th, 2014)
Phasing / Traffic and Parking
- **Town Hall Meeting 4** (January 14th, 2015)
Community/ Academic / Athletics and Recreation / Sustainability
- **Town Hall Meeting 5** (February 4th, 2015)
Financial Options / Cost Options / Tax Impact
- **Town Hall Meeting 6** (March 19th, 2015)
Recap / Summary / Options for Moving Forward



Code



Roofing



Windows



Envelope



Electric



Asbestos Roof Deck



HVAC



Plumbing



Composite of Issues

An aerial photograph of a suburban neighborhood. In the center, there is a large school complex with several buildings and a large oval-shaped sports field. To the left of the school, there is a large, dark, wooded area. To the right, there is a residential area with many houses and streets. The word "Appendix" is overlaid in the center of the image.

Appendix



Code



Roofing



Windows



Envelope



Electric



Asbestos Roof Deck



HVAC



Plumbing



Composite of Issues